

## Visualize with Accuracy

HCL Glovius



**HCL Glovius**

Glovius is an essential tool for professionals working in manufacturing industries requiring seamless access to diverse design/CAD files. Glovius offers a comprehensive solution to effortlessly visualize and analyze multiple design file formats.



View 3D & 2D CAD file. Save on CAD licence costs



Analyze designs faster with purpose built tools



Simple and easy to use. No training needed

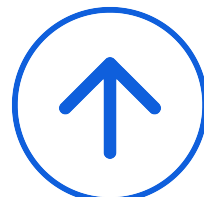

Export to STEP, 3D PDF and image formats

- Glovius is a modern CAD viewer. View CATIA, STEP, Creo, Solidworks, Inventor and other popular CAD formats.
- Available in subscription, permanent, and team licenses.
- Available in English, Deutsch, Français, Español, Portuguese, Korean, Chinese.

## VIEW AND NAVIGATE

- View 3D data, product structure, attributes, PMI, GD&T, and captures.
- Zoom, Pan, Rotate and Spin models.
- Standard and exploded views. previous and next view.
- Hide, Show, Isolate, Move, and Search components.
- Apply color and transparency.

## SECTION

- Cut dynamic sections along standard or custom planes.
- Create multiple sections and add hatching to enhance visibility.
- Create section profiles.

## ANALYZE DESIGN

- View dimensions, billet volume and mass, surface area and volume. Assign material density to calculate mass.
- View hole type, definition and quantity.
- Compare designs and highlight geometry difference.

## COMBINED ANALYSIS TOOLS

- Analyze thick and thin regions in components using thickness analysis tool.
- Compute draft angles.
- Calculate projected and section area.
- Move components and explode to analyze assembly structure.
- Detect clashes and contacts in assemblies using collision detection tool.

## MEASURE

- Take accurate linear, angular and radial measurements.
- Tape and surface area tools.
- Measure specific entities with filter selection.

## EXPORT

- Export to STEP, Parasolid, and IGES.
- Export to 3D PDF, 3D HTML, STL, PPT, and high resolution images.
- Generate bill of materials analysis and 3D reports.

## GLOVIUS MOBILE

View, share, and collaborate on the go with free iOS and Android apps.

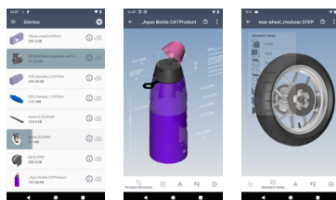

## GLOVIUS CLOUD

View 3D models in your browser, no installation needed. Glovius cloud account offers access to 3D data across devices.

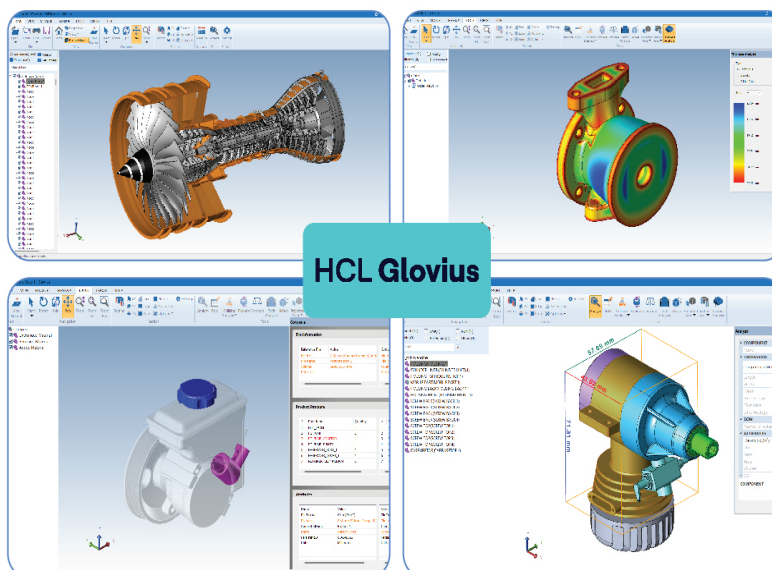

# HCLSoftware



## HCL Glovius

For more information:

Email: [marketing@glovius.com](mailto:marketing@glovius.com)

Visit: <https://www.glovius.com>

HCL Americas Inc: T +1.480.367.0132

Europe: M +49 151 4032 7429

APAC: T +91.20.40284444

---

## About HCLSoftware

HCLSoftware develops, markets, sells, and supports product families in the areas of Digital Transformation, Data, Analytics & Insights, AI & Automation and Enterprise Security platforms. HCLSoftware is the cloud-native solution factory for enterprise software and powers millions of apps at more than 20,000 organizations, including more than half of the Fortune 1000 and Global 2000 companies. HCLSoftware's mission is to drive ultimate customer success with its IT investments through relentless product innovation. <https://www.hcl-software.com>